

PUNCH DOWN TOOLS

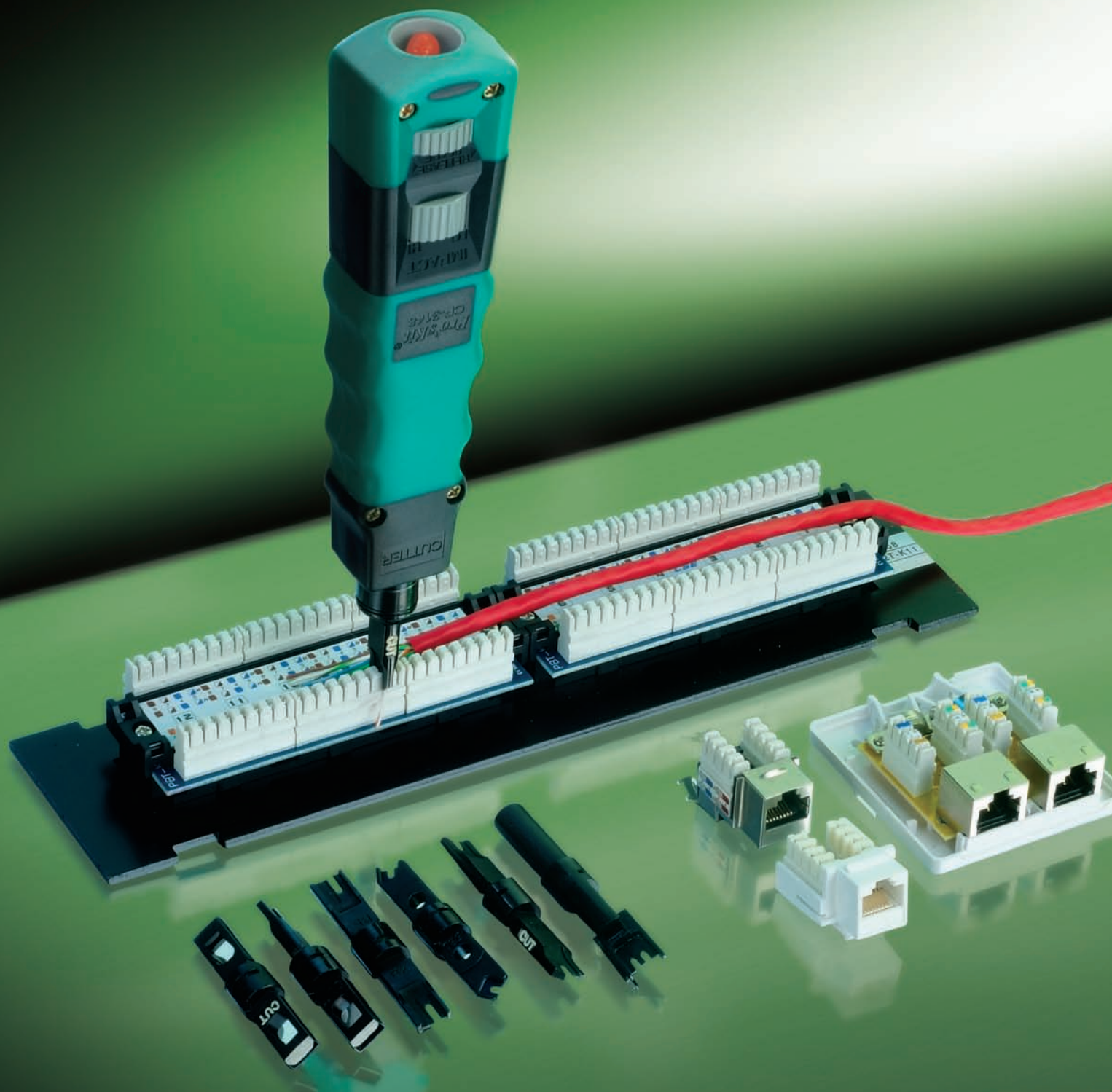

▶ CP-3148 / CP-3150 Impact and Punch Down Tool



- Ergonomic cushion grip with duplex color design, molded to shape of hand provides comfort and easy operation, non-slip grip.
- Spare blade storage chamber in handle.
- Increased HI/LOW forces to meet demands of all category cables through Cat6.



Storage for a spare blade



Impact



Round type holder

Model No.	Material		Application	Standard Blade type	Optional blade	O.A.L. (mm)	Individual packing
	Blade	Body					
CP-3148	SAE 4140	ABS+TPR	Hi-low adjust pressure (Hi: 40lbs 178N, Low: 30lbs /133N)	110/88 & 66 (5CP-16A)	5CP-16 series	162 (w/o blade)	Blister card
CP-3150				1pcs 110/88 & 1 pcs dual 66 with cut function (5CP-16, 5CP-16B)			

* 40 lbs =18kg, 30lbs =13.6kg

▶ PD-3141C Impact and Punch Down Tool



- A built-in combination hook/spudger for tracing and removing wires.
- Twist-lock style holder provides quick, easy blade changes and prevents pullout.
- An additional safe storage for one more spare blade

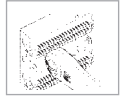

Wire-pull

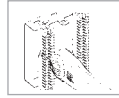

Wire-push



Impact



Round type holder

Material		Application	Standard blade type	Optional blade	O.A.L. (mm)	Individual packing
Blade	Body					
SAE 4140	TPR+PP (Anti-slip) (w/o Blade)	Hi-low adjust pressure(Hi:15±2kg, Low:10±2kg)	110/88	5CP-16 series	168 (w/o blade)	Blister card

▶ PD-3141D Punch Down Tool



- Twist-lock style holder provides quick, easy blade changes and prevents pullout
- An spare blade storage chamber in handle with cover
- The rubber grip handle provides easy operation and comfortable use.



Punch and cut cable terminals



Round type holder

Material		Application	Standard blade type	Optional blade	O.A.L. (mm)	Individual packing
Blade	Body					
SAE4140	Rubber (Anti-slip) (w/o Blade)	Anti-slip	110/88	5CP-16 series	115 (w/o blade)	Blister card

▶ 5CP-16 Series / 5PK-3140N-BIX Spare Blades



For CP-3148, CP-3150, PD-3141C, PD-3141D punch down tool



Model No.	For terminal block
5CP-16	Dual 66 type, one end with cut function
5CP-16A	66, 110/88 type, both end with cut function
5CP-16B	Dual 110/88 type, one end with cut function

5CP-16D	Dual 630A phone jack, non cut function
5CP-16BK	Dual KRONE 110 type, one end with cut function
5PK-3140N-BIX	BIX, with cut function

▶ CP-3140 Punch Down Tool with 110 Blades



Economic Type



Impact



Storage for a spare blade

Hex type	Model No.	For terminal block
	5CP-3140-110	Dual 110/88 type, one end with cuts function(Hex type)

Material		Application	Standard blade type	Optional blade	O.A.L. (mm)	Individual packing
Blade	Body					
SAE 4140	ABS	Hi-low adjust pressure (Hi: 15±2kg, Low: 10±2kg)	110/88 (5CP-3140-110)	5CP-3140-110(110)	186 (w/o blade)	Blister card

▶ 8PK-315DR Multi-Pair Impact Tool



- For use on LAN and telecom, seating 5 pairs UTP (24 AWG) at a time.
- Suitable for both 110 type cable side and cross-connect side terminals blocks.
- The termination block heel w/blades are changeable and reversible
- One end for seating and cut off wires, and the other end for seating wires only.



5PK-15B (4 pairs) For 110 type	5PK-15C (4 pairs) For modular jack	5PK-15D (5 pairs) For 110 type

Material		Application	Standard blade type	Optional blade	O.A.L. (mm)	Individual packing
Blade	Body					
SK 5	T.P.R (Anti-slip)	Hi-low adjust pressure (Hi: 15±2kg, Low: 10±2kg)	110 (5PK-15D)	5PK-15D/ 5PK-15B/ 5PK-15C	140 (w/o blade)	Blister card

▶ 8PK-324B Impact and Punch Down Tool



Flat type holder



Impact

Material		Application	Standard Blade type	Optional blade	O.A.L. (mm)	Individual packing
Blade	Body					
SAE 4140	ABS+Fiber	Impaction function	110/88 (5PK-14B)	5PK-14 series	114 (w/o blade)	Blister card

* 40 lbs =18kg, 30lbs =13.6kg

▶ 5PK-14 Series Spare Blades



For 8PK-324B punch down tool

Flat type holder



Model No.	For terminal block
5PK-14	Dual 66 type, one end with cut function
5PK-14A	Dual 66 110/88 type, both end with cut function
5PK-14B	Dual 110/88 type, one end with cut function
5PK-14C	Dual 66 110/88 type, both end w/o cut function

Model No.	For terminal block
5PK-14D	Dual 630A phone jack, non cut function
5PK-14BK	Dual KRONE 110 type, one end with cut function
5PK-14P	Dual PANASONIC 110 type, one end with cut function

▶ PD-3141EN / PD-3141EBN Mini Punch Down Tool



- Nonslip rubber handle for user comfort.
- Comes with fixed blade and cut function.



Punch and cut cable terminals



Model No.	Material		Application	Standard blade type	O.A.L. (mm)	Individual packing
	Blade	Body				
PD-3141EN	SAE 4140	Rubber (Anti-slip)	Fixed blade , not changable	66 (with cutter)	129	Blister card
PD-3141EBN				110/88 (with cutter)		

▶ CP-3145A / CP-3145B Punch Down Tool



- ABS grip handle and light weight design provides user comfort.
- Rotatable blade holder for easy selection of proper blade type end.
- Perfect for small jobs and the do-it-yourself installer.



Punch and cut cable terminals



- Rotatable blade holder
- Blade on both ends



Model No.	Material		Standard blade type	O.A.L. (mm)	Individual packing
	Blade	Body			
CP-3145A	S45C	ABS	110/88 blade, one end with, one end without cut function	128	Blister card
CP-3145B	110/88 type: S45C 66 type: SAE 4140		66, 110/88 type, both ends with cut function		

▶ CP-3141 Impact Terminal Tool for KRONE



Economic Type



Wire-pull



Impact



Wire-pull



Impact

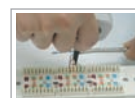

Wire-pull



Impact

Model No.	Material		Application	Standard blade type	O.A.L. (mm)	Individual packing
	Blade	Body				
CP-3141	S45C	ABS	Combination impact and torque tool function. Both side (screwdriver & wire-pull function)	KRONE	175	Blister card
8PK-3141A						
8PK-3141B						